

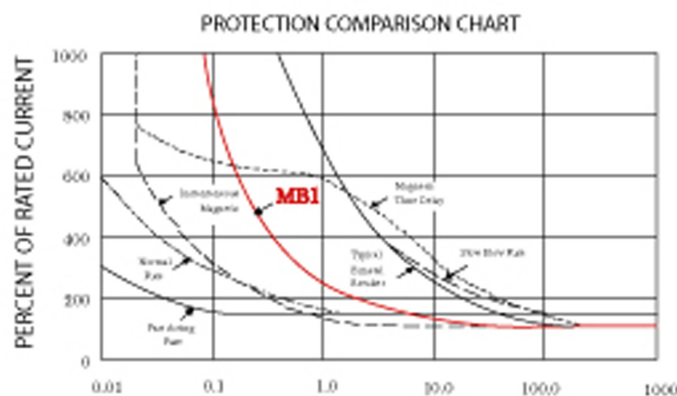

The scope of its use is limitless.

RoHS compliance along with worldwide safety agency certification, provides global acceptance of this ultra miniature supplementary circuit breaker.

The trip times indicated below represent published specifications for the protector that must hold 100% of rating & must trip 135% within 1 hour. These broad specs do not reflect actual production where units are manufactured to much closer tolerances. This control capability enables SAI to meet special applications with little difficulty. Examples of these are: Trip must occur within 1 minute @ 135% load; another requires trips within 8 minutes @ 120% load. We invite inquiries concerning the difficult & the opportunity to demonstrate the significant improvement in the state-of-the-art as achieved in the MB1 circuit protector.



The Model MB1 has the perfect combination of fast response to overloads yet adequate delay to prevent nuisance tripping.

SPECIFICATIONS

Current Ratings:

2.5, 3, 4, 5, 6, 7, 8, 9, 10, 12, 13, 14, 15, 16, 18, 20, 25

(AC/DC) Voltage:

250 VAC maximum 32 VDC maximum

Interrupting Capacity:

1000A @ 250 VAC 200 A @ 32 VDC
 * 2000 A @ 125 VAC (8 amp thru 25 amp)

* MEETS NEWLY REVISED REQUIREMENTS
 FOR CIRCUIT PROTECTION OF U.L. STANDARD 1363
 "RELOCATABLE POWER TAP"

Dielectric Strength: 1500 VAC 50/60 Hz

Certification:

UL #80246 (M) Standard 1077

CSA # LR 60314-2

TUV # E9371085.02

SEMKO # 953308901

VDE # 93528 & # 6180UG (IEC934)

Time vs. Current

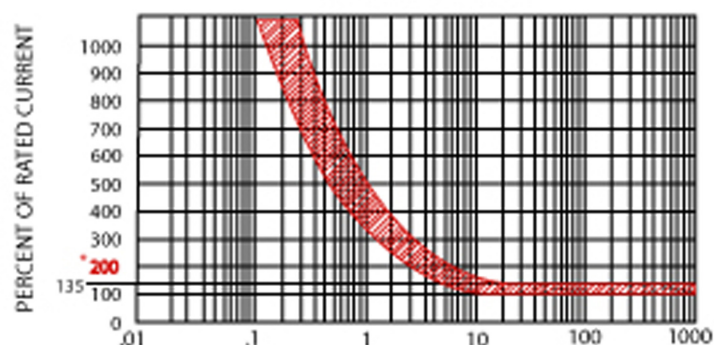

100% overload = NO TRIP @ 25 & 40 degrees C

200% overload = 2.6 - 6.5 seconds 250% overload = 1.5 - 3.1 seconds

300% overload = .96 - 1.8 seconds 400% overload = .48 - .92 seconds

600% overload = .21 - .39 seconds

MOUNTING MEMEBERS



PANEL NUT (Standard)
 "PUSH-RESET"
 embossed

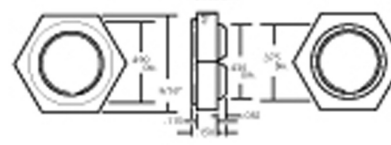

HEX NUT (Standard)
 For 1/2" knock-out panel
 up to .385 thick or 3/8" knock-out
 in panel up to .350 thick.

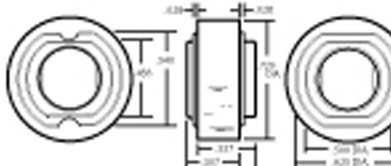

SPACER BUSHING (optional)
 Accomodates "D", double "D"
 and round cut-out holes.
 5/8" diameter hole on .023 to .093
 panel. 1/2" diameter hole in up to
 .065 panel.

COMPATIBLE PANEL CUT-OUTS

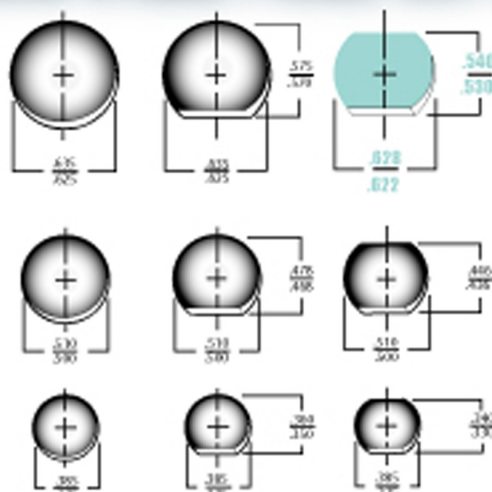

SNAP-IN
 HOLE DETAIL